



P.O. Box 1135, Midland, MI 48641  
989-492-0042  
info@sosar.org  
www.sosanimalrescue.org

SOS Animal Rescue Newsletter • Volume 23, Issue 2 • August 1, 2023

## Give Local Midland

Thank you to everyone who donated on May 2 to Give Local Midland. Our fund is SOS Animal Rescue Personal Pet Assistance Fund at the Midland Community Foundation.

### 2023

\$10,560	donations
1,961	matching funds
300	prizes
<hr/>	
\$12,821	
\$102,892	total donations to date



### Examples of pets your donations helped

- Dog with broken leg
- Two cats with sores on body
- Dog with prolapsed vagina needing surgery
- Dog with pyometra infection needing surgery
- Cats needing flea meds
- One dog with parvovirus
- One dog with allergies needing antibiotics and other medication
- Three dogs with open wounds needing cleaning and antibiotics
- Two cats with blocked urinary tracts
- One cat with euthanasia
- One cat with pyometra, a uterine infection
- One cat with an ear infection
- One cat with a broken leg



navy blue shirt with powder blue highlights and medal

## SOS EVENTS

### Dirty Dog Trail Run

#### August 18

Packet Pick-Up  
6:00–7:00 p.m.  
Midland City Forest

#### August 19

Walk-Up Registration  
8:00–8:45 a.m.  
Race Start  
9:00 a.m.  
Midland City Forest

### Pooches at the Pool

#### September 9

see Midland Parks & Rec  
website for details

### Board Meeting

#### November 16

6:00 p.m.  
see website for details

Visit [petfinder.com](http://petfinder.com) to find pets available for adoption.

## VOLUNTEERS NEEDED!

To help with Dirty Dog Trail Run registration and/or course monitoring on Saturday, August 19 from 8:00 to 11:00 a.m., please email us at [info@sosar.org](mailto:info@sosar.org).

# THANK YOU!

Darlene Burnham  
Kathy Card  
Paul and Lily Cheng  
Jill Freeland  
Joy Marchione  
Elizabeth Marshall  
Cathy and Steve Mercier  
Greg Nelson  
Linda Rector  
Madeline Sasse  
Judy Scheuffele  
Terry Shell  
Gene Thompson

In memory of Chloe,  
beloved companion of  
Andy and Hannah  
from Michael and Diana Dalton

Thank you to the anonymous donor  
for the grant to help fosters with  
serious medical issues.  
So far we have used the funds to  
fix a broken leg, provide fluids and  
antibiotics to a very sick cat,  
and provide dental work on a cat  
with gingivitis.

## Platinum Sponsors

All About Animals – Flint  
M-20 Animal Hospital  
Next Home Park Place Homes Group  
Northern Animal Clinic  
Precious Cat  
River Rock Animal Hospital  
Superior Title and Settlement  
Surrey Veterinary Clinic  
Target  
Vetmed of Midland

## Gold Sponsors

leuter Insurance Group / Auto Owners  
Insurance  
Larkin Food Center  
Legacy Wealth Management –  
Benjamin F. Edwards & Co.  
Meijer  
Pet Pals  
Soldan's Pet Supplies

## Silver Sponsors

Animal Medical Center  
Beauchamp's Heating and Cooling LLC  
Bushey's Automotive  
DeFi Creations  
Eastman Party Store  
The Gourmet Cupcake Shoppe  
Horizon Bank  
Member's First Credit Union  
PetSMART  
Spherion  
UPS Store – Midland  
Valley Lanes  
Wildfire Credit Union

## Bronze Sponsors

Auto Technicians Inc  
Bone and Bailey Insurance  
Family Fare  
Garber Chevrolet  
Grape Beginnings Winery, LLC  
Howl-A-Day Pet Resort  
Hugs for Homeless Animals  
Kroger  
LaLonde's Market  
Lowe's  
Max's Place  
Midland Amateur Radio Club  
Midland Animal Clinic  
Midland Soccer Club  
Muddy Pups  
Paula's Pet Sitting  
Quilts for Cages  
Runners Athletic Company  
Shay Water Company  
Shine of Midland  
Tractor Supply Company  
Zach's Dog Groomery

Thank you to everyone who  
volunteered, donated, shopped, and  
helped clean up at our rummage sale!



# THANK YOU!



**Support us with your Kroger purchases!**

**Community Rewards  
Number:  
HN771**

**In 2023 Kroger donated \$75  
for a total of \$1925 to date!**

## Canister Hosts

Auto Technicians  
Bicycle HQ  
Cohoon's Elevator  
Countryside Animal Health Center  
The Gourmet Cupcake Shoppe  
Howl-A-Day  
Larkin Food center  
Lodge Party Store  
M-20 Animal Hospital  
Max's Place  
Midland Liquor  
Muddy Pups  
Nature's Niche  
Northern Animal Clinic  
Ray's Bike Shop - Eastman Road  
Soldan's Pet Supplies  
Woodland Pet Resort

## For Top Sponsorship in the Dirty Dog Trail Run

Northern Animal Clinic,  
M-20 Animal Hospital, and  
Superior Title and Settlement



## Dirty Dog Trail Run Sponsors

### Awards Sponsor

M-20 Animal Hospital  
Northern Animal Clinic  
Superior Title and Settlement

### Event Sponsors

leuter Insurance Group / Auto Owners Insurance  
Legacy Wealth Management - Benjamin F. Edwards  
Next Home Park Place Homes Group  
Pet Pals  
River Rock Animal Hospital  
Soldan's Pet Supplies

### Race Sponsors

Animal Medical Center  
Beauchamp's Heating and Cooling  
Bushey Automotive  
Eastman Party Store  
Horizon Bank  
Members First Credit Union  
Spherion  
UPS Store - Midland  
Valley Lanes  
Wildfire Credit Union

### Sign Sponsors

Auto Technicians Inc  
Bone & Bailey Insurance Agency  
Isabella Bank  
Midland Animal Clinic  
Muddy Pups  
Paula's Pet Sitting  
Shine of Midland  
Zach's Dog Groomery

### Prizes/Silent Auction

ACE Hardware  
Anderson's Stained Glass  
Beauchamp's Heating and Cooling  
Beyond Measure Bulk Foods  
Dan Dan the Mattress Man  
Howl-A-Day Pet Resort  
leuter Insurance Group / Auto Owners Insurance  
LaLonde's Market  
Lisa Davis  
Michele Gunkelman  
Nature Niche  
Runners Athletic Company  
Soldan's Pet Supplies

### Race Supplies, Treats, Water

Family Fare  
Meijer  
Shay Water

### Race Communications

Midland Amateur Radio Club

### Race Course Management

Dig Deep Races

### Moving Sign Ads

Garber Chevrolet  
Midland Soccer Club



## 5 Back-to-School Pet Toxins to Keep on Your Radar

With many school districts continuing remote-only learning this fall, there's a potential for pets in the home to be exposed to more school-related toxins.

### Snacks

Common snacks like grapes and raisins can cause renal failure in dogs and may be more readily accessible to pets if they are loose and unprotected by lunch boxes. Exposed pets need to have vomiting induced at home or a veterinary clinic, and their renal values should be monitored. If a pet has an adverse reaction to ingesting grapes or raisins, they will often show spontaneous vomiting within 48 hours. These pets should be treated with IV fluid diuresis to help protect the kidney function.

### Science Projects

School science projects may also bring additional concerns when done in the home. For example, volcano projects often use baking soda as an ingredient in the simulation of a volcanic eruption. Ingestion of large amounts of sodium bicarbonate can lead to GI irritation, abdominal distention/bloat, and vomiting and diarrhea. There are also concerns for elevations in sodium, decreases in potassium, and the development of alkalosis and hypocalcemia. These patients should be treated with IV fluids and acid-base status and electrolytes should be monitored and corrected as indicated by the blood values.

### Craft Projects

Common, homemade craft projects like play dough and salt dough can lead to elevations of the sodium level in the pet ingesting them. Left untreated, we can see the development of tremors and seizures due to the electrolyte imbalance created by high sodium levels. These pets need IV fluid therapy with lower sodium fluids and warm water enemas to bring sodium back to normal levels. If this treatment is not pursued, death may

result. Ingestion of homemade slime is another possible hazard that could negatively impact your clients' health.

### Medications

Students with ADD or ADHD may now be taking their medications at home, which is another potential risk to pets. Medications such as Adderall®, methylphenidate, Ritalin®, Focalin®, and Vyvanse® are in the amphetamine family, and when ingested by dogs and cats, will cause significant stimulatory signs and serotonin syndrome. Treatment of this ingestion involves fluid therapy and the use of acepromazine and cyproheptadine to control the agitation and serotonin syndrome signs. Seizures should be controlled with Keppra and phenobarbital. These pets need to be monitored in the clinic for at least six to eight hours after the clinical signs have resolved.

### Pollen and Mold

Fall brings the potential for increased pollen and mold allergies. Many people with seasonal allergies rely on albuterol inhalers. Dogs often mistake these inhalers for chew toys, and when punctured, the dog can develop imbalances in electrolytes, elevated heart rate, and potential hypertension. Treatment of this toxicity requires fluid therapy and beta blockers such as propranolol, esmolol, atenolol, or metoprolol to bring the heart rate down to normal levels. Imbalances in potassium and phosphorus may also need to be addressed.

Awareness of these school-related pet toxins on the part of parents and students may prevent emergency visits and keep pets safe while children are learning from home.

*Reprinted from [www.aspcapro.org](http://www.aspcapro.org).*

ASPCA | (888) 426-4435  
Animal Poison Control Center

## 2019 Top Toxins Breakdown by State

For expert animal toxicology advice, call (888) 426-4435

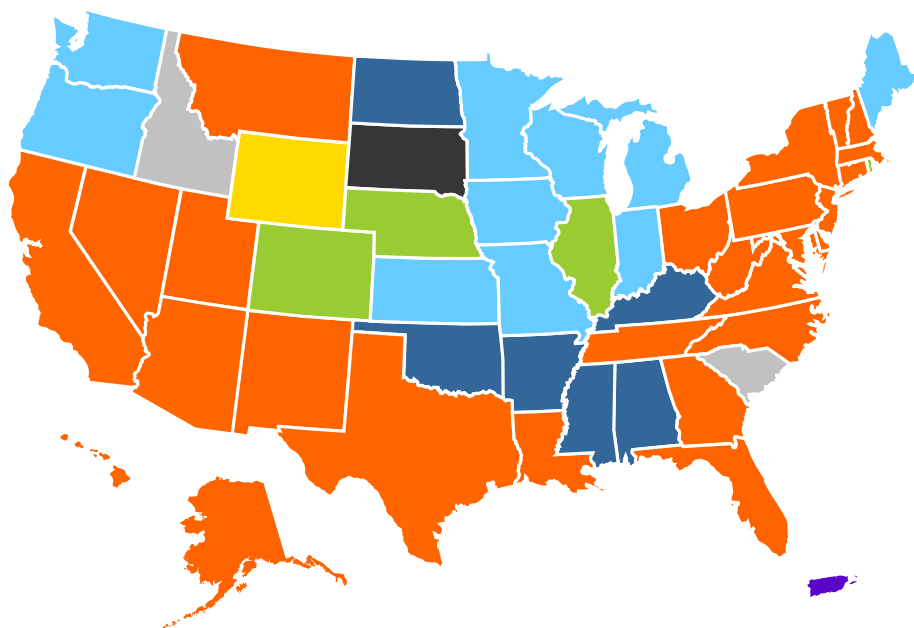

Chocolate



Anticoagulant Rat Poison



Xylitol



Bromethalin Rat Poison

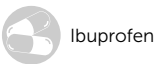

Ibuprofen



Vitamin D



Fly Attractant



Warfarin



# Pet Pool Safety



If you're spending time by the water this summer, make sure to keep your pets away from these common dangers!

**Undiluted pool chemicals** are extremely corrosive, and if ingested will cause severe ulcers in the mouth, throat and esophagus which can even become life-threatening.

**!** Watch for drooling, oral sores, mouth pain, vomiting, anorexia, bloody vomit/stool.

**Salt water pools and oceans** can cause life-threatening hypernatremia if your pets drink an excessive amount and no fresh water is available.

**!** Watch for extreme thirst, vomiting, dehydration, impaired balance or coordination, tremors, seizures

**Pool water**, while greatly diluted, contains chlorine and algicides to make the water suitable for swimming.

**!** Watch for mild vomiting, diarrhea

**Sunscreens and bug sprays** may contain chemicals that could be harmful to pets if ingested or applied topically.

**!** Don't use sunscreens or bug repellants on your pets unless they are marked as safe for animals.

**Alcohol**, even in small amounts, is extremely dangerous to pets if ingested and can even result in death.

**!** Watch for vomiting, diarrhea, decreased coordination, central nervous system depression, difficulty breathing, tremors, abnormal blood acidity, coma

**ASPCA** | (888) 426-4435  
Animal Poison Control Center

If your pet has been exposed to any pool chemicals, salt water, or alcohol please contact APCC or your veterinarian.  
For more information, please visit [aspc.org/apcc](https://www.aspc.org/apcc)



## Spay/Neuter Statistics

Thanks to your donations and support, we are able to provide more help each year. If each spay/neuter surgery prevents two litters of unwanted puppies or kittens from being born the program has saved over 40,000 from a life of hunger, cruelty, and disease.

Spay/Neuter	thru 2022	2023	Total
Female Cats	2555	72	2627
Male Cats	2103	84	2187
Female Dogs	744	5	749
Male Dogs	604	15	619
Total	6006	176	6182

# Best Treatment Options for Heatstroke in Pets

When temperatures rise, clinics may see more victims of heatstroke. Some of the most common causes of this life-threatening condition in pets include:

- Being left in a hot car
- Exercising outside in warm weather
- Prolonged, unattended use of a dryer after bathing
- Being left outside with no water or shade

Brachycephalic breeds, including bulldogs, pugs, and Boston terriers, are pre-disposed to heat stroke due to their anatomy. Older and overweight animals are more susceptible to heatstroke as well.

## What is Heatstroke?

Heatstroke, also known as severe hyperthermia, is very dangerous because it can lead to multi-organ failure due to inflammation, changes in tissue perfusion, and altered coagulation. Neurologic signs such as collapse, ataxia, and seizures can be seen due to decreased blood flow to the brain.

Renal failure is a relatively common aftereffect to heatstroke because of decreased blood flow to the kidneys.

Severe hyperthermia can lead to myocardial necrosis; arrhythmias can be seen due cardiac hypoperfusion, and the pulmonary endothelium can be damaged, leading to pulmonary edema.

Blood flow can also be compromised to the gastrointestinal tract leading to hemorrhagic gastrointestinal signs, bacterial translocation and sepsis. Disseminated intravascular coagulation (DIC) can occur as well.

## How to Treat a Dog or Cat with Heatstroke

If a patient presents to you with significant hyperthermia, stabilize the patient first and then get a history. Typically, IV fluids and thermoregulation are very important. Fans, cool towels, an icepack on the fluid line, and water on the paw pads can be helpful to get the temperature under control.

Often these patients are in shock and need fluid resuscitation. Because pulmonary edema can be seen



with heat stroke, patients may need oxygen support as well. Once you stabilize the patient, blood work and other supportive measures can be performed. Symptomatic and supportive care may include gastroprotection, antibiotics, mannitol, and dextrose.

When taking a history from the owners, ask about any situations mentioned above where the patient could have been at risk for heatstroke. Because prolonged seizures can also lead to hyperthermia, it is important to ask if the patient's signs started with seizing.

There are a few products that can lead to hyperthermia as a result of a toxicity so asking about any possible exposures can be helpful as well. Products that can lead to severe hyperthermia include hops (*Humulus lupulus*), 5-HTP, marijuana, methylxanthines, such as caffeine and chocolate, and any product that can cause serotonin syndrome.

The prognosis for patients with heatstroke tends to be guarded. If the patient presents hypoglycemic, has prolonged clotting times, develops renal failure, or develops DIC, then the prognosis is poor.

*Reprinted from [www.aspcapro.org](http://www.aspcapro.org).*

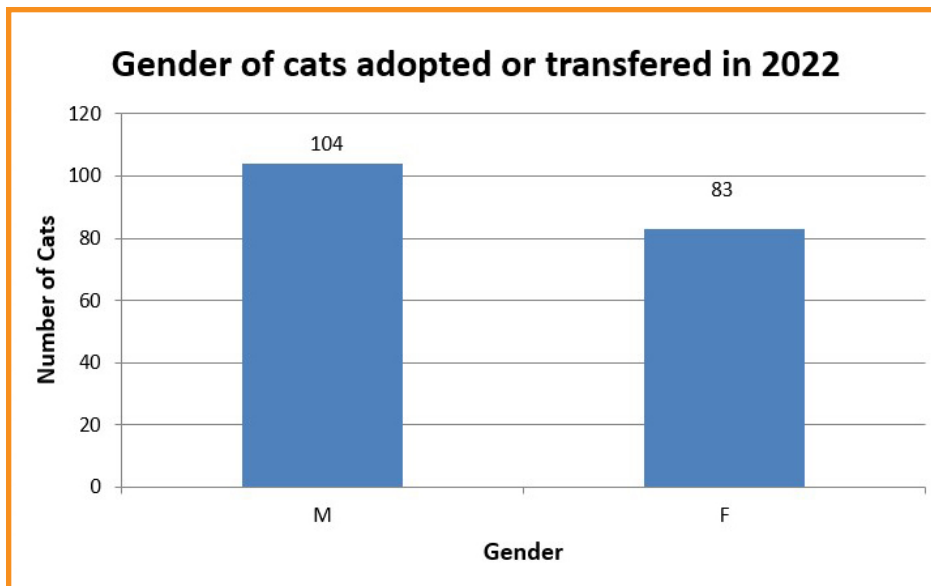



# YOUR DONATIONS HELP THESE ANIMALS RECEIVE MEDICAL CARE

Big Tom - wounds on face; adopted

gray kittens - coccidia

Mikki - broken leg; adopted

Yum Yum - upper respiratory infection

Emmie - four teeth needing to be pulled

Cougar - uterine infection; adopted



Emmie



Cougar

ADOPTED!



Yum Yum



Big Tom

ADOPTED!



Mikki

ADOPTED!



gray kittens



PORTION OF PROCEEDS GO TO



14<sup>th</sup> Annual

# Dirty Dogs

Trail Run



Saturday, August 19, 2023

Midland City Forest

THANK YOU, AWARD SPONSORS



THANK YOU, EVENT SPONSORS



THANK YOU, RACE SPONSORS



Medals for Overall Winners in Each Division With & Without Dogs

PACKET PICK-UP:  
Friday 8-18  
6:00-7:00 PM  
Midland City Forest

Questions?  
989.492.0042

## LOCATION & COURSE

All events start and finish at the City Forest trailhead located at 2840 E. Monroe Rd. (1/4 mile west of Eastman Ave.), Midland, Michigan.

The course is a combination of unpaved two-track and single-track trails that twist and turn over flat land and steep hills in scenic woods. City Forest is a 520-acre preserve of woods, creeks, marshes, and bridges, making for an enjoyable and challenging off-road run. Don't want to spend time in hilly trails? Then join the one-mile walk!

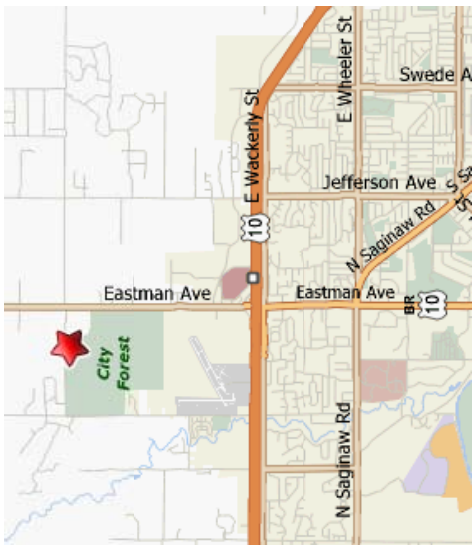



# SOS Animal Rescue Dirty Dog Trail Run

## REGISTRATION FORM

### SCHEDULE OF EVENTS

- 8:00 AM Registration opens
- 9:00 AM 5K Run/Walk & 10K Run w/o dogs
- 9:05 AM 5K Run/Walk & 10K Run with dogs
- 9:16 AM 1 Mile Walk

### RACE FEES

PRICING:	Before 8-1	8-1 to 8-16	Day of Race*
10K Run	\$30	\$35	\$40
5K Run/Walk	\$25	\$30	\$35
1 Mile Walk	\$15	\$15	\$15

\*Shirts are only guaranteed with registration before August 1 and are optional for an additional \$10.

### REGISTRATION

#### Online:

Sign up online at [www.itsyourrace.com](http://www.itsyourrace.com). Online registration closes at midnight on August 16.

#### Mail:

Send registration form and check payable to "SOS Animal Rescue" to Shelley Park Cluff at 801 Joe Mann Blvd., Ste. P#4, Midland, MI 48642.

#### Day of Race:

Available 8:00–8:45 AM near the race start.

#### Divisions:

Men's, Women's, and 13 & Under.

### PLUS

All participants will receive bag on race day with items as provided by our sponsors. Silent auction will close when the race winners are announced.

Pet participation is encouraged but not required. If you do bring a dog, we ask you to be considerate of your dog's ability and limitations. All dogs are to be kept on leashes, no exceptions.

Race management by Dig Deep Races. Chip timing and immediate race results by Miller Race Management.

### PURPOSE OF THE RUN

Shelterhouse provides funding to ensure victims of domestic violence can provide a safe haven for their pets.

SOS Animal Rescue of Midland County provides funding for animals in need through their foster, pet food, and spay/neuter assistance programs.

Come join the fun and support two great causes! Sign up online.

**Questions?** Call 989-492-0042 or email [info@sosar.org](mailto:info@sosar.org).



First & Last Name \_\_\_\_\_

Address \_\_\_\_\_

City, State ZIP \_\_\_\_\_

Email \_\_\_\_\_

Main Phone/Cell \_\_\_\_\_

Male  Female Age on Race Day \_\_\_\_\_

10K Run  5K Run/Walk  1 Mile Walk

I am running with my dog  Yes  No

Shirt Size (Men's)  S  M  L  XL  2XL

Shirt Size (Youth)  S  M  L

Registration Fee \$ \_\_\_\_\_

Shirt (optional for \$10.00) \$ \_\_\_\_\_

Charity Donation made in honor of \$ \_\_\_\_\_

TOTAL DUE \$ \_\_\_\_\_

Name of honoree as you would like it to appear in post-race printed materials \_\_\_\_\_

Check Enclosed (payable to SOS Animal Rescue)  
Please accept my entry in the SOS Dirty Dog Trail Run. I state that I am physically fit for the event I entered. I waive any rights I may have against SOS Animal Rescue, it's volunteers, directors, sponsors, vendors, or contractors for damage or injuries occasioned by my participation in any SOS Dirty Dog event. I also authorize SOS Animal Rescue to utilize any photographs, personal narrative, interviews, or audio and video recording of my participation for any and all purposes.

Signature \_\_\_\_\_

(Parent/Guardian signature required if participant is under 18.)

Date \_\_\_\_\_

Emergency Contact Name and Phone Number \_\_\_\_\_

**Send form and check to Shelley Park Cluff,  
801 Joe Mann Blvd, Ste P#4, Midland, MI 48642.**

## Color of Pet vs Days in our Care

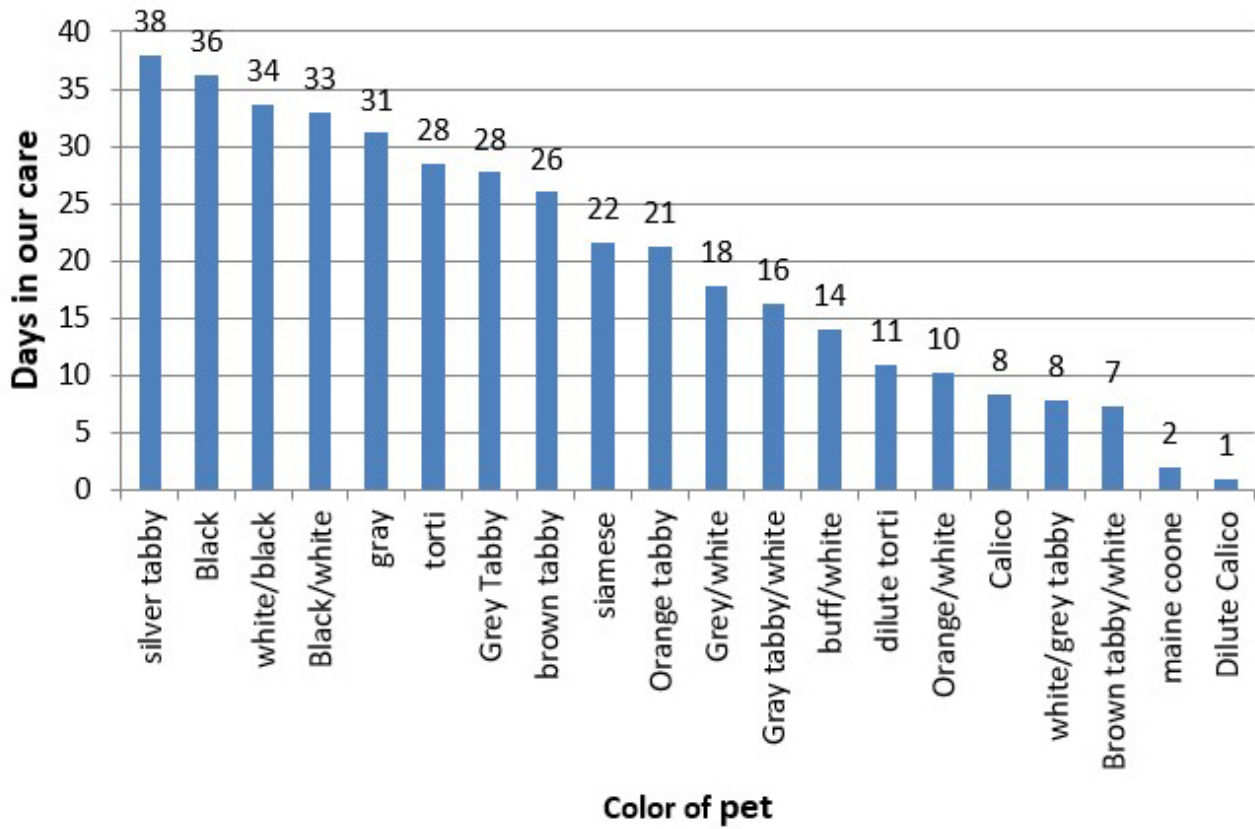

## Color of Cats Adopted in 2022

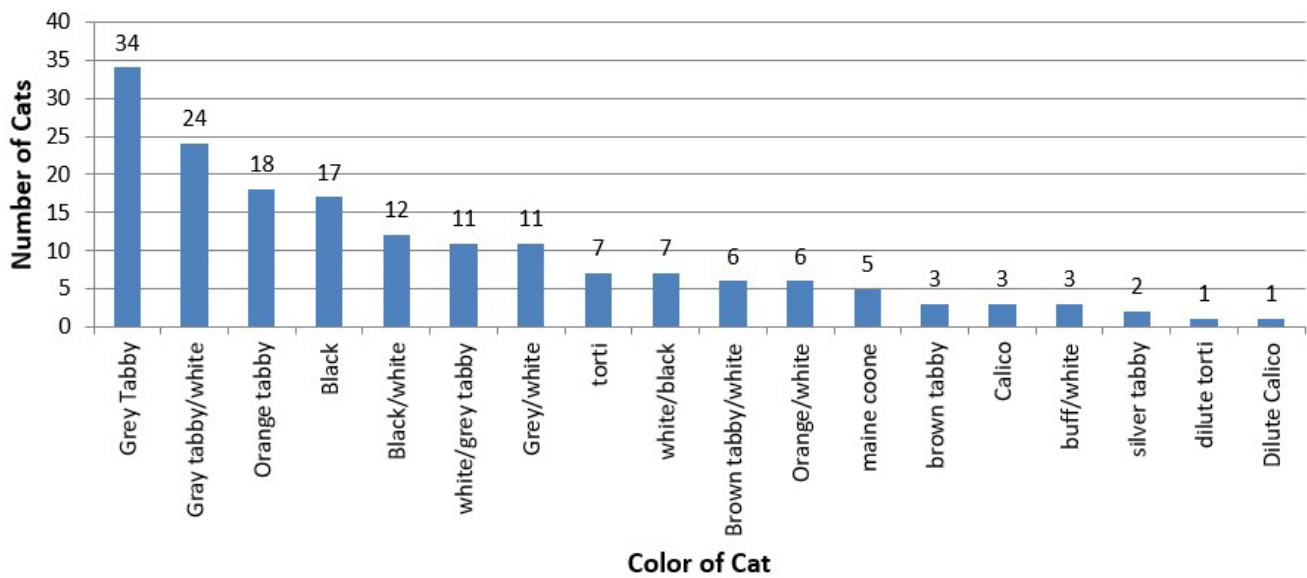

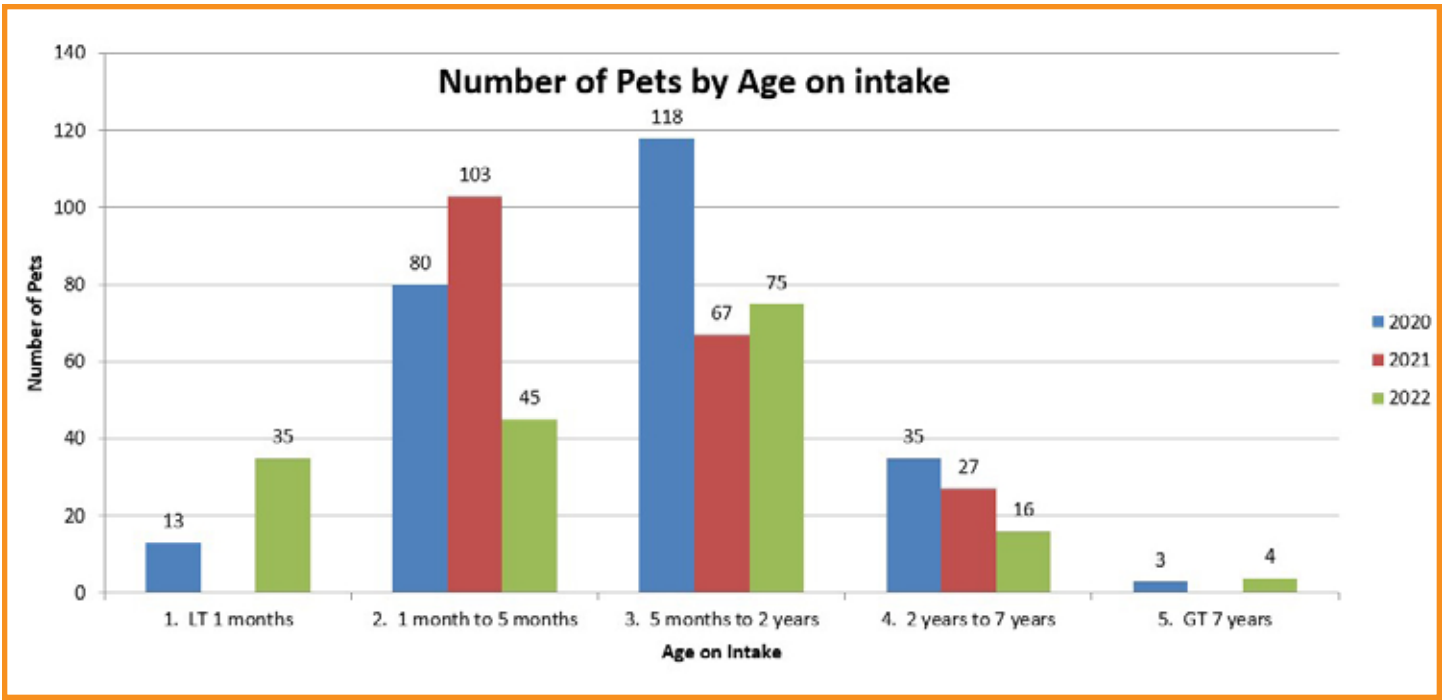

<b>Pet Food Assistance Program</b>		<b>Thru 2022</b>	<b>2023</b>	<b>Total</b>
	Families Helped	1329	143	1472
	Dogs	1602	146	1748
	Cats	2486	195	2686
	Other Animals	38	5	43
	Pounds Dog Food Delivered	49,131	4937	54,068
	Pounds Cat Food Delivered	25,951	1970	27,921

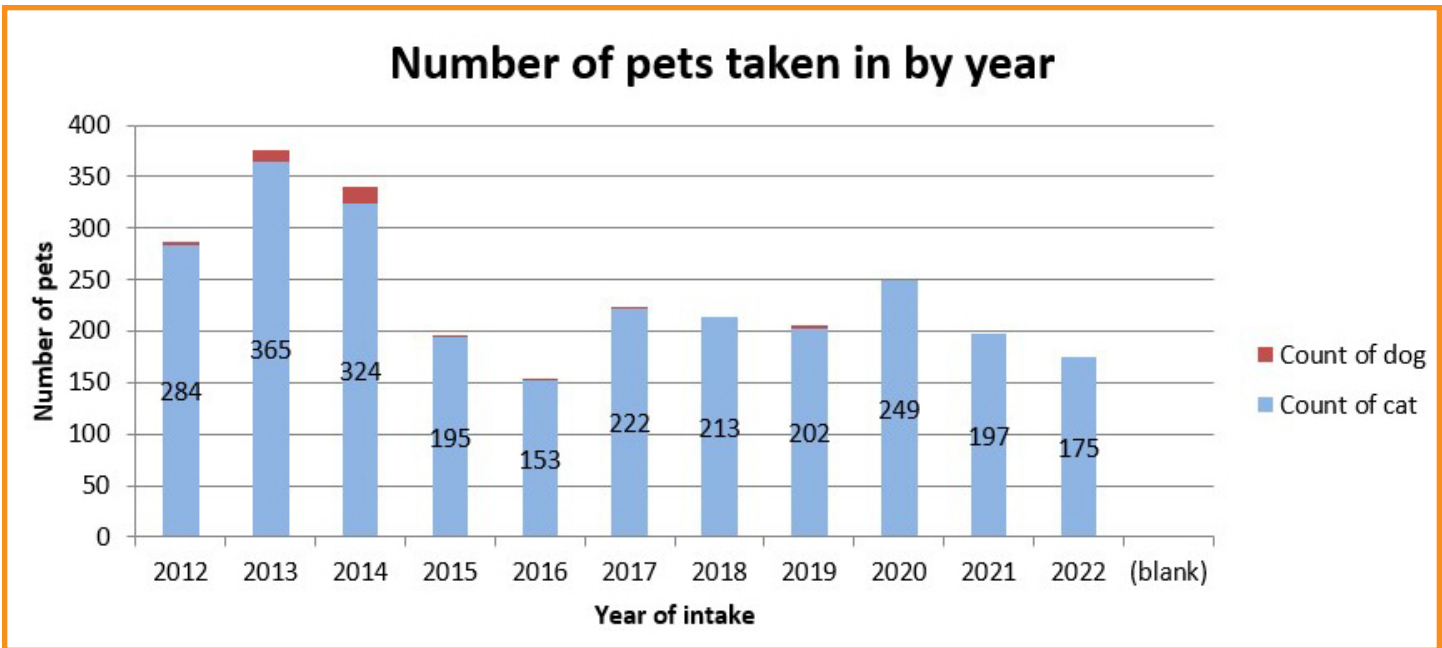





P.O. Box 1135, Midland, MI 48641-1135

989-492-0042

info@sosar.org

www.sosanimalrescue.org

www.facebook.com/sosanimalrescue



**Dirty Dog Run**  
**Saturday, August 19, 2023**  
**Midland City Forest**

**Officers**

Joann Taylor, President  
Shelley Park, Vice President  
Karla Oldenburg, Treasurer

**Mission Statement**

SOS Animal Rescue is a non-profit 501(c)3 organization whose mission is to reduce the number of unwanted pets in the Midland area through placement, public education, spay/neuter assistance programs, and support for the efforts of local animal welfare groups.

**Directors**

Isabella Jansen

**Newsletter Editor**

Sheryl Billmeier Hnizda

**THANKS TO OUR PLATINUM & GOLD SPONSORS!**



Surrey Veterinary Clinic



Midland VetMED

